

1	KS558	2	KS762	3	KS572	4	KS585	5	KS771	6	KS576	7	KS577	8	KS628	9	KS657	10	KS545	11	KS611
12	KS793	13	KS661	14	KS546	15	KS564	16	KS569	17	KS649	18	KS644	19	KS547	20	KS676				

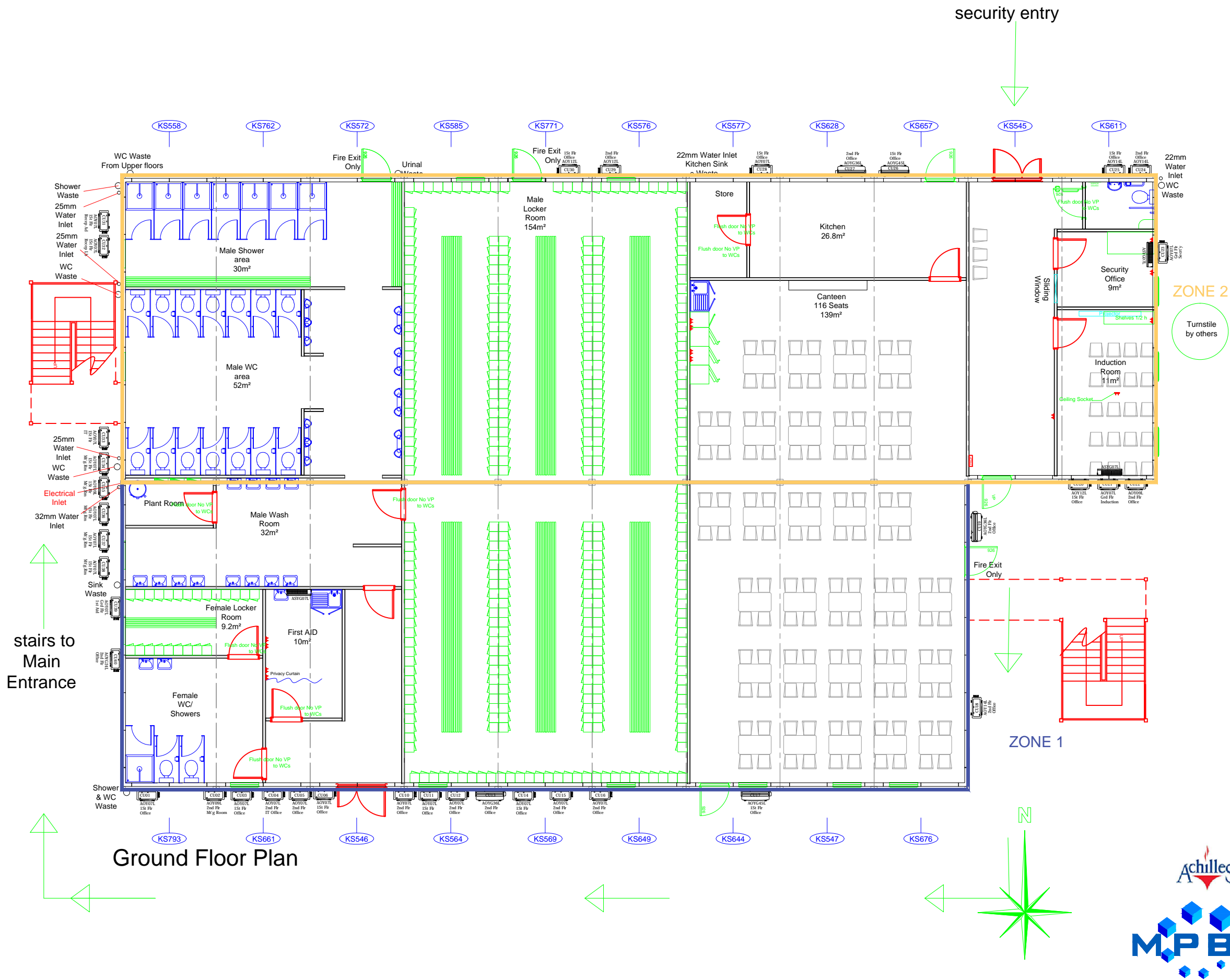

THIS DRAWING IS THE PROPERTY OF ad MODULAR LTD AND MUST NOT BE USED, RE-ISSUED, COPIED OR REPRODUCED IN ANYWAY WITHOUT WRITTEN CONSENT. NO RECTIFICATION WORK OR DEVIATION FROM DRAWING IS ACCEPTABLE WITHOUT WRITTEN CONSENT FROM ad MODULAR LTD

DO NOT SCALE
IF IN DOUBT ASK

NOTES

Window sizes & positions to suit availability
(Sale projects dependant on final building position and may change once agreed).

Door sizes & positions to suit availability
(Sale projects dependant on final building position and may change once agreed).

Steps & Ramps Shown Indicative Only
Furniture Shown Indicative Only

- Ground Floor:
- 100amp 3 phase for A/C board
 - 200amp 3 phase supply for TP+N mains board
- First Floor:
- 100amp 3 phase supply for TP+N mains board
- Second Floor:
- 100amp 3 phase supply for TP+N mains board

(4 x supplies overall)

NB: Canteen/Kitchen area supply by others

Building Comprises of 60 No. 9.6m x 3m modules Triple Storey.
UNIT TYPE:
KS NUMBERS: Stock Drawing Only
Final Layout to be confirmed

Rev	Date	Description	By
-	-----	-----	---

ad
modular accommodation

Radway Green Road
Alsager
CW1 5UJ
Tel: 0800 533 5360
Email: info@admodular.com
Web: www.admodular.com

CLIENT
Sales

TITLE
Modular 60 Bay Ground Floor

CONTRACT NUMBER
1277-200-02

DRAWN BY MH	SCALE 1:125@A3	DATE 11/04/2018
----------------	-------------------	--------------------

DRAWING No AD-1588-203-01	REV --
------------------------------	-----------

THIS DRAWING IS THE PROPERTY & COPYRIGHT OF ad MODULAR LTD AND
MUST NOT BE USED, RE-ISSUED, COPIED OR REPRODUCED IN ANYWAY
WITHOUT WRITTEN CONSENT. NO RECTIFICATION WORK OR DEVIATION
FROM DRAWING IS ACCEPTABLE WITHOUT WRITTEN CONSENT FROM
ad MODULAR LTD

NOTES

Door sizes & positions to suit availability
(Sale projects dependant on final building
position and may change once agreed).

- Ground Floor:
 - 100amp 3 phase for A/C board
 - 200amp 3 phase supply for TP+N mains board
- First Floor:
 - 100amp 3 phase supply for TP+N mains board
- Second Floor:
 - 100amp 3 phase supply for TP+N mains board

NB: Canteen/Kitchen area supply by other

UNIT TYPE:
KS NUMBERS: Stock Drawing Only
Final Layout to be confirmed

ad 
modular accommodation

Radway Green Road
Alsager
CW1 5UJ
Tel: 0800 533 5360
Email: info@admodular.com
Web: www.admodular.com

TITLE	Modular 60 Bay First Floor
-------	----------------------------

DRAWN BY	SCALE	DATE
MH	1:125@A3	11/04/2018

DRAWING No	REV
AD-1588-203-02	--

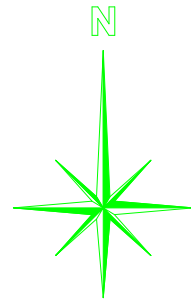

First Floor



1	KS675	2	KS687	3	KS689	4	KS549	5	KS695	6	KS680	7	KS672	8	KS671	9	KS669	10	KS696	11	KS668
12	KS542	13	KS677	14	KS679	15	KS670	16	KS678	17	KS694	18	KS686	19	KS693	20	KS767				

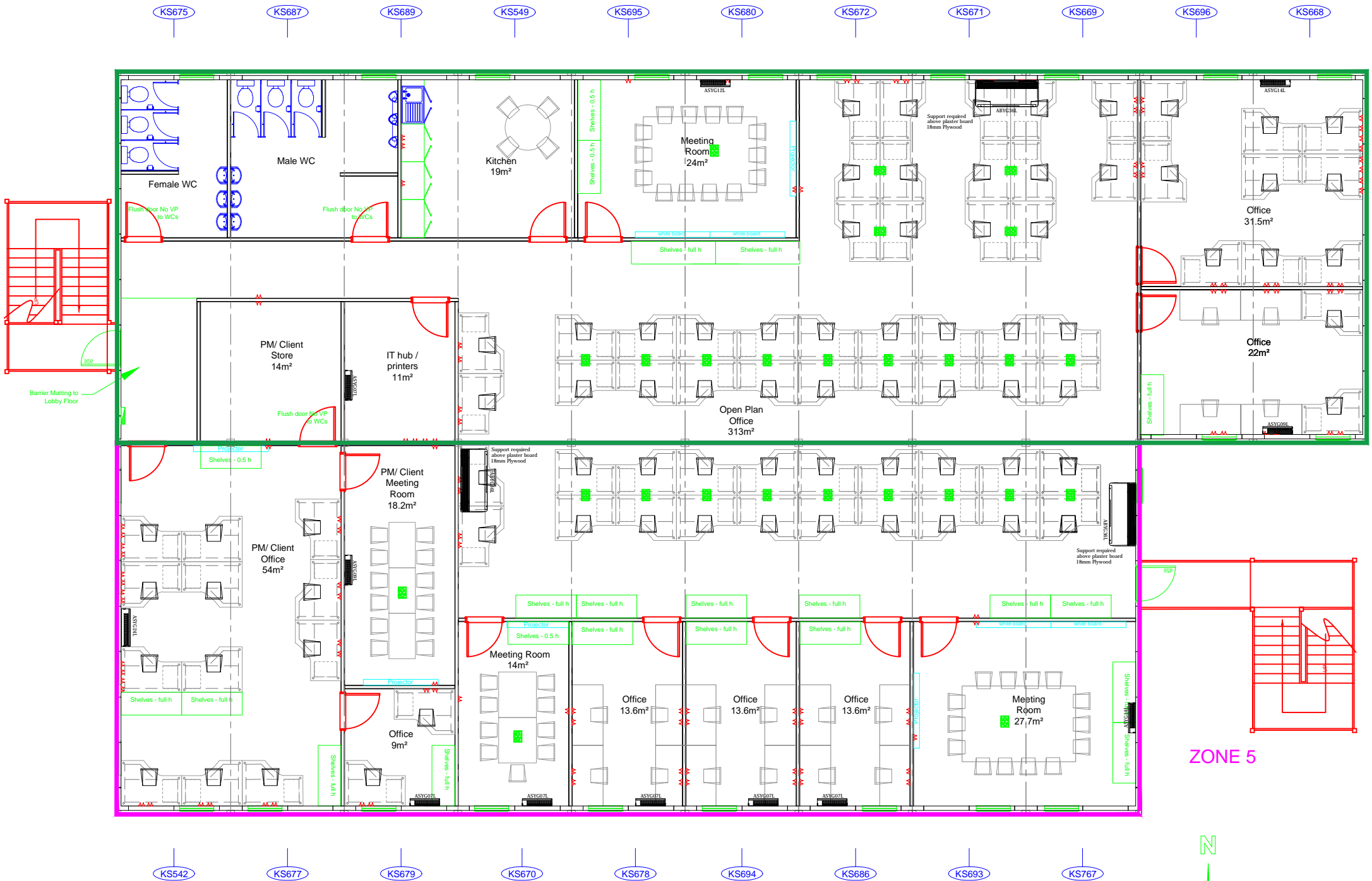

Second Floor

THIS DRAWING IS THE PROPERTY & COPYRIGHT OF ad MODULAR LTD AND MUST NOT BE USED, RE-ISSUED, COPIED OR REPRODUCED IN ANYWAY WITHOUT WRITTEN CONSENT. NO RECTIFICATION WORK OR DEVIATION FROM DRAWING IS ACCEPTABLE WITHOUT WRITTEN CONSENT FROM ad MODULAR LTD

DO NOT SCALE
IF IN DOUBT ASK

NOTES

Window sizes & positions to suit availability
(Sale projects dependant on final building position and may change once agreed).

Door sizes & positions to suit availability
(Sale projects dependant on final building position and may change once agreed).

Steps & Ramps Shown Indicative Only
Furniture Shown Indicative Only

- Ground Floor:
- 100amp 3 phase for A/C board
 - 200amp 3 phase supply for TP+N mains board
- First Floor:
- 100amp 3 phase supply for TP+N mains board
- Second Floor:
- 100amp 3 phase supply for TP+N mains board

(4 x supplies overall)

NB: Canteen/Kitchen area supply by others

Building Comprises of 60 No. 9.6m x 3m modules Triple Storey.
UNIT TYPE:
KS NUMBERS: Stock Drawing Only
Final Layout to be confirmed

Rev	Date	Description	By
-	-----	-----	---

ad
modular accommodation

Radway Green Road
Alsager
CW1 5UJ
Tel: 0800 533 5360
Email: info@admodular.com
Web: www.admodular.com

CLIENT
Sales

TITLE
Modular 60 Bay Second Floor

CONTRACT NUMBER
1277-202-02

DRAWN BY MH	SCALE 1:125@A3	DATE 11/04/2018
----------------	-------------------	--------------------

DRAWING No AD-1588-203-03	REV --
------------------------------	-----------

